

VILLAGE OF LAWTON

Parks & Recreation Master Plan



2021 - 2025

TABLE OF CONTENTS ERROR! BOOKMARK NOT DEFINED.

Chapter 1 - Introduction.....	1
Chapter 2 - Community Description	1
Chapter 3 - Administrative Structure	3
Chapter 4 - Recreation Inventory.....	6
Chapter 5 - Community Input	11
Chapter 6 - Goals and Objectives.....	15
Chapter 7 - Action Plan	18
Chapter 8 - Summary and Conclusion.....	19
Appendix A - Survey.....	20
Appendix B - Public Notices	51
Appendix C - Resolutions.....	52

INTRODUCTION

The 2021 – 2025 Parks and Recreation Master Plan is a guide for the future development of parks and recreation facilities, operations, and maintenance in the Village. The Village recognizes the significant role that recreation plays in providing a high quality of life and improved physical health of its citizens, so this effort to create the Village of Lawton's first Parks and Recreation Master Plan was undertaken to guide the orderly development of such facilities and programs.

This plan provides the data and direction to ensure that parks and recreation offerings are aligned with the community needs and values. The plan addresses current recreation issues and identifies and prioritizes future needs of the community and the means for meeting those needs over the upcoming five-year period. This plan will form the basis for future applications for recreation grant funding from the Michigan Department of Natural Resources (MDNR) and other granting agencies. The Plan was prepared in accordance with the MDNR's Guidelines for the Development of Community Park, Recreation, Open Space and Greenway Plans.

The foundation for the development of the parks and recreation plan is to develop a strategy to further enhance the health and recreational opportunities within the village and to provide a common direction for future development and enhancements to parks, additional trails, and routes. The intent of this plan is to develop parks, recreational opportunities, and trail systems (non-motorized) to provide safer facilities and more choices for healthier lifestyles.

Village of Lawton staff has taken on the duties of drafting this document. To gather information regarding programming and park development, the Village utilized the online services of Survey Monkey to collect public opinion, the plan represents the best interpretation of the desires of the clients being served. This plan will provide a road map that staff and elected officials will use to guide these services for the next five years.

COMMUNITY DESCRIPTION

Historically, Lawton was first identified as a village in 1853 when Nathan Lawton first filed a description of a plat of land in the office of the County Clerk of Cayuga County New York. It was officially incorporated on November 3, 1858. Its wonderfully rich soils made it

perfect for growing grains and fruits, making Lawton renowned for its vineyards and harvests. Today, Lawton is home to the oldest standing winery and remains a premier grape growing area in the Midwest.

The Village of Lawton is a General Law Village incorporated within Antwerp Township on three sides, with Porter Township bordering to the south. Lawton is in Van Buren County, which is bordered by Allegan County, Kalamazoo County, Cass County, Berrien County, and Lake Michigan. Located in Southwest Michigan, Lawton is home to approximately 1,852 residents (based on the 2010 US Census).

Lawton is a desirable place to live with historic small-town charm. The Downtown District is the heart of the community. It is regionally known for its fine dining establishments and a premier microbrewery. In addition to outstanding dining options, downtown is home to several service industries and some shopping. Welch's Foods is a large industrial grape cooperative, producing tens of thousands of gallons of sparkling juices each year in downtown Lawton.

Lawton is located on M-40, a State Highway that runs North and South. It is three miles south of I-94 a federal Highway. These two main transportation arteries give Lawton easy access to more populated urban amenities while maintaining its individual small-town identity.

Many visitors come to the greater Lawton area during the summer to enjoy outdoor recreational opportunities such as boating, fishing, and swimming. Wintertime activities include ice-fishing and snowmobiling.

NATURAL FEATURES

Lawton enjoys a picturesque hilly topography that is characteristic of vineyards. The slopes of the hills are gently rolling and are very inviting for outdoor activities like hiking or snowmobiling.

Lawton is surrounded by many lakes which are a draw for in state and out of state visitors who enjoy these waters for fishing, swimming, and skiing. Lawton is one of the few communities in Michigan that allow snow mobiles to drive on local streets.

ECONOMIC FRAMEWORK

Lawton is a bedroom community. Most people use their personal vehicle to drive to and from work. People can easily commute to

larger metropolitan areas for work and still have a lifestyle that is not available in larger employment centers.

The Village of Lawton is comprised of many different types of building and land uses. Housing is primarily single- or two-family homes with a multi-unit apartment complex that is for subsidized and affordable housing.

The greater Lawton Area and Van Buren County are home to many regional tourism destinations such as winery's, micro brewery's, lakes, resorts, auto racing and snowmobiling. There are over 3,000 homes held for seasonal or vacation uses. Many out of state residents own summer houses in the lakes area surrounding Lawton.

Due to its unique soils, the greater Lawton area is home to numerous vineyards, fruit farms and other agriculturally based businesses. Grape/fruit processing and vegetable preservation and canning are important industries and provide many jobs and a large tax base for the community.

ADMINISTRATIVE STRUCTURE

The Village of Lawton is a General Law Village, governed by a Village Council which consists of six Trustees and one Village President. These positions are elected to four-year terms by the residents. The Village operates under a Council / Manager form of government, hiring a Village Manager to oversee all village departments. The Village currently employs twelve full-time employees, several seasonal summer employees, two crossing-guards during the school year, and one part-time employee.

The Village does not have a special commission responsible for parks and recreation but utilizes an "ad-hoc" committee to develop plans and goals for municipal recreation sites. The committee, however, has no direct authority to implement any proposal or expense.

Daily operations and maintenance of Lawton's parks and recreation facilities are the responsibility of the Department of Public Works (DPW). The DPW is responsible for the maintenance of the parks, streets, and the municipal water / sewer system, and consists of a staff of five full time individuals as well as seasonal staff as needed. As with most small communities, the Village relies on volunteers to

organize and maintain most of the recreation programs and events provided within the Village limits.

VILLAGE OF LAWTON ORGANIZATIONAL CHART

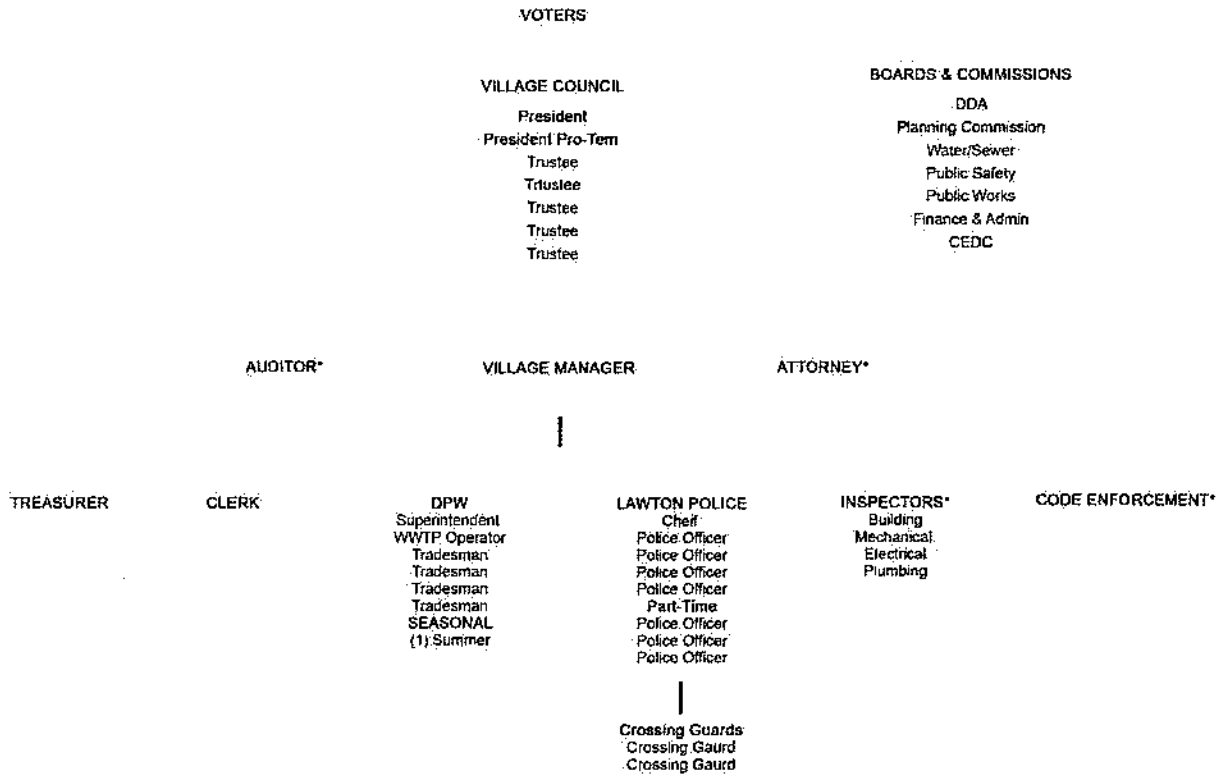

PROJECTED BUDGET

The Village Council is responsible for determining the operating budget and capital improvements for the parks and recreation programs for Village facilities. They are also responsible for appointing positions, approving projects and grants, the purchase or sale of land, and serving on various committees.

Funding for the Village of Lawton Parks and Recreation comes from Village tax dollars distributed through the General Fund.

PARKS DEPARTMENT	2019-20 AMENDED BUDGET	2020-21 AMENDED BUDGET	2021-22 PROPOSED BUDGET
FICA	1,250	1,500	1,650
DEFERRED COMPENSATION	700	700	770
M.E.S.C.	250	250	275
OPERATING SUPPLIES	2,500	2,500	3,000
ELECTRIC	2,000	3,000	3,000
EQUIPMENT MAINTENANCE	1,000	1,000	1,100
VEHICLE RENT	10,000	10,000	11,000
KID'S DREAM IMPROVEMENTS	2,000	2,000	2,200
PARKS TOTAL:	33,700	37,950	41,745

During fiscal year 2020-2021 the Parks and Recreation budget was \$37,950. Maintenance of the parks was the largest expense. For the previous five years, this has been the Villages' practice with budgeted expenses relatively flat in the General Fund.

During the 2019 – 20 Fiscal year, the Downtown Development Authority began raising to construct a splash pad at the Chancy Lewis Park. Including a Patronicity matching grant for \$40,000. In total, \$142,000 was raised to construct the new Splash Pad in Chancy Lewis Park. It officially opened in June of 2020 and came in under-budget at \$116,000. The remaining DDA fundraising revenue is being reserved for additional park and recreation improvements in Chancy Lewis Park.

VOLUNTEERS IN THE PARKS AND RECREATION PROGRAM

The Village of Lawton often utilizes volunteers in maintenance and beautification roles in Village Parks and downtown. DDA Board members volunteer to plant and maintain flower beds and planters in the Downtown District, Cannon Park, and the North and South gateways to the Village. Clubs and teams (Football, Basketball, Baseball/softball, National Honor Society) from the high school often volunteer for special events and park "clean-up" days.

PARTNERSHIPS WITH NON-PROFIT AND OTHER PUBLIC AGENCIES

Lawton Youth Baseball and Softball is the organization that arranges and operates the youth baseball program within the

Stephyn Sports Complex. Approximately 200 participants are involved from the region, including a portion residing outside of the Village of Lawton. The Lawton Rocket Football organization runs and manages the rocket football fields.

Senior citizen activities are coordinated through Senior Services which provides Adult Day services, counseling, health and fitness, Meals on Wheels and transportation.

A local Farmer's Market is held weekly at Chancy Lewis Park from July through October.

The Village of Lawton Museum is a volunteer organization that is available year-round by appointment.

The Lawton Lions Heritage Community Center & Grape and Wine Museum is a regionally renowned facility that hosts large events such as weddings. The museum portion is nestled in the huge wine cellars of the complex. The center itself is a unique architectural structure of cobblestone located in the heart of the "Fruit Belt" of southwest Michigan. The 1903 structure, a state and national historic site, is the state's oldest standing winery building which makes it a most appropriate setting for the Museum.

Other programs that occur during the year include:

- Easter Egg Hunt – organized by a local church and volunteer group
- Memorial Day Parade – a parade through the Village ending with a ceremony at the Oak Grove Cemetery
- Ride for Wishes – A fundraising bike ride for terminally ill children – usually in June
- Summerfest – A 4th of July Celebration with a one-day street festival with parade, music and fireworks
- Fall Homecoming Parade – a tradition provided by the Lawton Consolidated School District in honor of Lawton Alumni
- Christmas Parade – A winter evening parade featuring lights and sounds of the season that winds through downtown

RECREATION INVENTORY

In order to plan for parks and recreation in the future, the types of facilities that currently exist in the Village need to be examined. It is also helpful to compare these existing facilities to various standards as

one measure of the adequacy of the parks and recreation facilities in the area.

PARK CLASSIFICATION SYSTEM

The Recommended Classification System for Local and Regional Open Space from the Michigan Department of Natural Resources (MDNR) defines several types of parks. Five of these are applicable to and found within the parks owned and operated by the Village of Lawton. A Mini-Park is less than one acre in size and is less than 1/4 mile from a residential setting. It is used to address limited, isolated or unique recreational needs. School-Parks can combine parks with school sites to help meet the recreational space needs for the community.

Community Parks serve a broader purpose to an area. They have more amenities and usually serve two or more neighborhoods within 1/2 to three miles and are generally 30 - 50 acres in size. A Special Use facility is oriented toward single-purpose use, such as a football complex. A Natural Resource Area is land that is set aside for the preservation of significant natural resources, remnant landscapes, open space, and visual aesthetics or buffering. The five classifications of parks that can be found in the Village of Lawton are Mini-Park, School Park, Special Use Facility, Community Park, and Natural Resource Area.

The Village of Lawton currently has five public parks, a private golf club, and several public-school facilities scattered throughout the Village. Below is a Park Facilities Chart providing an inventory of recreational opportunities. A map with park and school locations follows on the next page.

Village of Lawton Parks and Recreation Facilities Inventory

	Cannon Park	Chancy Lewis Park	Village Conservation Area	Stephayn Sports Complex	Rocket Football Fields	Lawton Community School Facilities
Accessibility	3	2	1	1	1	3
Park Type*	MP	CP	NRA	SUF	SUF	SP
Area (Acres)	0.3	7.2	173.0	30.0	2.6	30.0
Water Access	No	No	No	No	No	No
Service Area	Village	Community	Community	School District	School District	School District
Ball Diamonds				7		2
Pavillon		2				
Basketball Court		4				2
Benches	1	5		2	2	
Bike Rack		2				
Bleachers		4		4		Various
Concession Area				1		2
Disc Golf Course						9 holes
Football Field					1	1
Grill		4				
Horseshoe Plts		4				
Park Sign	1	1		1		
Parking		Yes		Yes		Yes
Picnic Tables		22				
Playground		1				1
Restrooms	**	1		1	**	Various
Soccer Field				1		1
Splash Pad		1				
Storage Area		1		2		Various
Tennis Courts		1				
Volleyball						2
Water Access						
Other	Veteran's Memorial					

*Park Type: MP=Mini Park; CP=Community Park; NRA=Natural Recourse Area; SUF=Special Use Facility; SP=School Park

** = Portable Restroom.

VILLAGE OF LAWTON PARKS AND RECREATION FACILITIES MAP

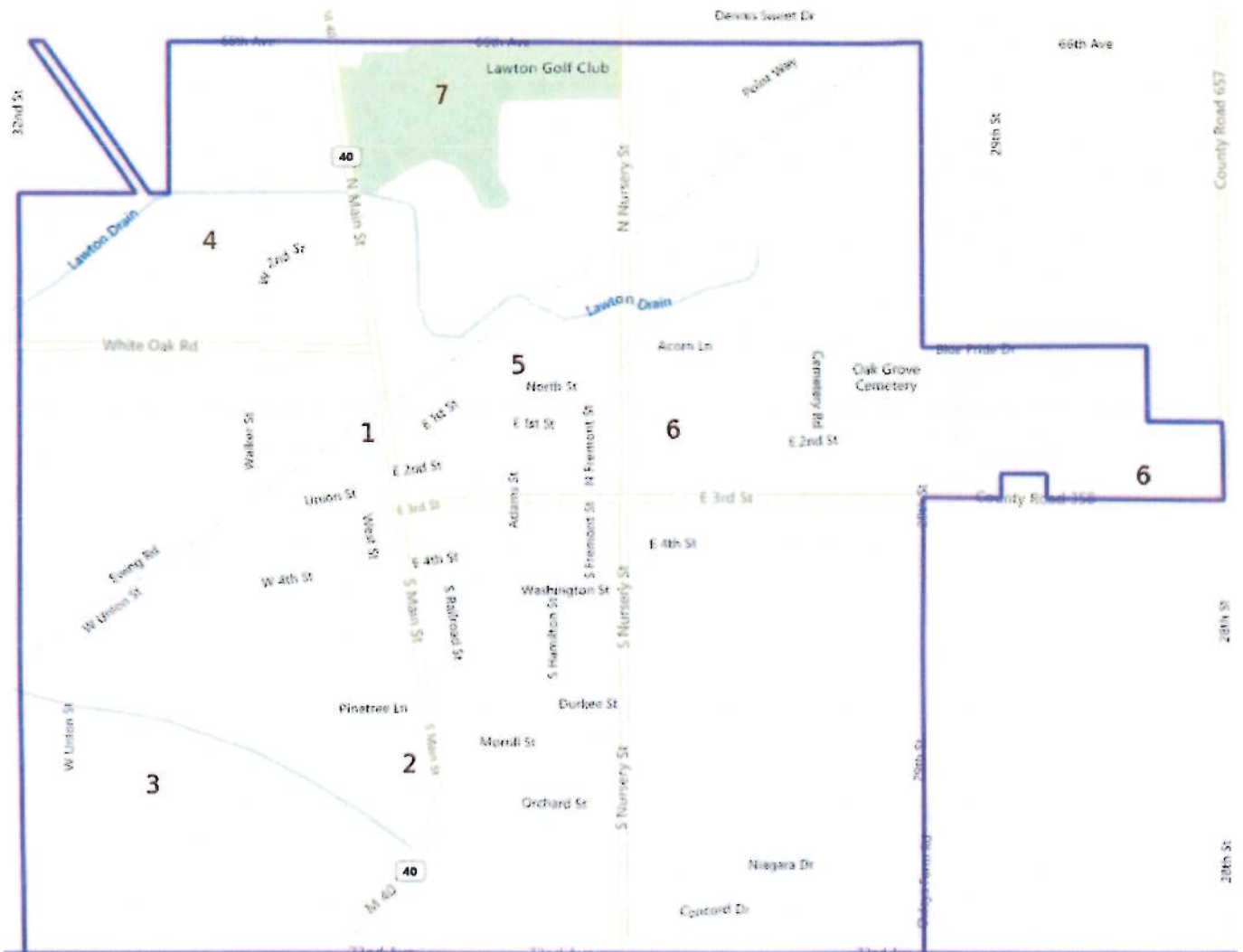

- 1. Cannon Park
- 2. Chancy Lewis Park
- 3. Village Conservation Area
- 4. Stephayn Sports Complex

- 5. Rocket Football Fields
- 6. Lawton Community Schools
- 7. Lawton Golf Club

PARKS AND RECREATIONAL FACILITIES: DESCRIPTIONS

Lawton offers its residents 5 recreational facilities with a variety of capacities for active and passive recreation. Below is a description of each facility, which includes a brief description of its amenities.

Cannon Park

Type of Park: Mini-Park

Accessibility Rating: 3

Area (acres): 0.3

Cannon Park is a mini park that features Lawton's Veteran's Memorial at the northern gateway to downtown. Holiday displays are created in the park for the summer, fall, and Christmas seasons. It also hosts a snowmobile trial in the winter maintained by the Southwest Michigan Snow-stompers.

Chancy Lewis Park

Type of Park: Community Park

Accessibility Rating: 2

Area (acres): 7.2

Chancy Park is situated at the southern edge of the Village. The park was the site of Lawton's first baseball park in the late 1800's and continued with that use until the 1950's. During the 50's the location was used for showing outdoor movies and had an ice-skating rink until the 1980's when it fell into disrepair.

The park now offers two covered pavilions with picnic tables, a large 'community built' play structure, horseshoe pits, a tennis court, and 3 half-court basketball courts. During the summer of 2020, a splash pad was constructed. The park also offers picnic tables, grills, and several large open space fields for various recreational uses. There is a heated barrier free bathroom that is available year-round. The Farmer's Market is also held in the park July through October, and snowmobilers use portions of the park for parking during the winter.

Village Conservation Area

Type of Park: Natural Resource Area

Accessibility Rating: 1

Area (acres): 173

This property is a large, wooded area along the west side of the Village. It is a primarily wooded area that residents often hike to relax, bird watch and view wildlife in their natural habitat. While the area is not maintained by the Village, many traversable paths have been carved over the years.

Stephayn Sports Complex

Type of Park: Special Use Facility

Accessibility Rating: 1

Area (acres): 30

The Lawton Youth Baseball and Softball organization manages and maintains the Stephayn Sports Complex. The park has 7 ball fields and a soccer field. It also has a concessions and restroom facility and a storage area.

Rocket Football Field

Type of Park: Special Use Facility

Accessibility Rating: 1

Area (acres): 2.6

The Rocket football Field is a Special Use Facility that is primarily used in the fall for rocket football and cheerleading practices and games. The rocket football organization maintains the fields.

Lawton Community Schools

Type of Park: School Park

Accessibility Rating: 3

Area (acres): 30

There are two primary areas for recreation offered by Lawton Community Schools. A large playground is located to the north of the elementary building. This is open for neighborhood use when school is not in session. A soccer field is located at the Middle School, and there is a Disc Golf on both the Middle School and High School grounds. The High School also offers 4 Gymnasiums (3 for competitions, 1 for community events such as youth sports), 1 multipurpose room (available to rent), a Weight Room, space for

vocal and instrumental music, the Owen Bray Auditorium (seats 400), 4 baseball and softball fields, and Packer Stadium for football, soccer, and track (seats 1200).

PUBLIC FACILITIES OUTSIDE OF LAWTON

Huzzy Lake, Bankson Lake, Bankson Lake Cedar Lake, Gravel Lake, Eagle Lake, and Three Mile Lake all have public access for fishing. Maple Lake has a public access for fishing and swimming

Private Facilities in or near Lawton

Pin High Golf Course is an eighteen-hole golf course located within the Village limits.

Lake Cora Golf Course is an eighteen-hole public golf course that is within ten miles of the Village limits.

Copper Grille has a banquet facility located downtown in the historic Village Hall that can host private parties specializing in weddings.

The Lions Club operate the regionally renowned Lawton Community Center that annually host wedding receptions, Wine-Tasting festivals and many other events.

A snowmobile trail runs through Lawton that annually attracts thousands of snowmobilers; Lawton is one of the few communities in Michigan that allow snow mobiles on the public side streets.

There are numerous grape vineyards and fruit farms that offer roadside markets and u-pick opportunities for those interested in agritourism.

CURRENT FUNDING HISTORY

The Village has not previously received any grant funding from the Michigan Department of Natural Resources (MDNR).

COMMUNITY INPUT

With the successful construction of the Splash Pad in Chancy Lewis Park, use of Village park facilities has soared. The Village Council has since decided to increase emphasis on parks and recreation and initiate its first Parks and Recreation Master Plan. This Plan will provide the basis for public policy decisions and technical coordination in recreational development within the Village.

One of the most important aspects of a community's Recreation Plan is the inclusion of resident's opinions about how they view the future of their parks and recreation system. To comply with the Michigan Department of Natural Resources' Guidelines for the Development of Community Park, Recreation Open Space and Greenway Plans, the Village of Lawton offered two opportunities for public input, along with a 30-day period for review and comment on the draft Recreation Plan.

SURVEY

An online community input survey was offered to the community for three weeks during December 2020. The survey was publicized with a variety of methods, including a Facebook advertisement, community flyers with QR code link to the survey, the Village Newsletter mailed with water bills, an article in local newspaper, as an item on the DDA, Planning Commission and Council Agenda, and an Email blitz to City contacts. All of the responses are included in Appendix

COMPARISON TO STANDARDS

The Village of Lawton has approximately 243 acres of total park space for its 2010 population of 1,852 residents. General industry standards would suggest 5 to 20 acres of total park space per 1,000 citizens, or approximately 10 to 37 acres of total park land for the Village of Lawton.

From this standpoint, the Village exceeds standards in each of its categories of parks and recreational facilities, except for one. Mini parks should be at .5 acres and is slightly under at .3 acers. In general, the centrally located school playground and other open space make up for that deficiency. (See the table below) One area for growth may be in Lawton's park trail facilities.

As discussed later in the public input section, there is high support in Lawton to begin a formal trail network and interest in providing increased pedestrian access.

The satisfactory amount of existing open space should not inhibit the City from seeking new recreational lands when conditions are appropriate.

Comparison to Standards – Park Acreage				
	Recommended Acres Per 1,000 Population	Existing Acreage	Recommended for Lawton	
			Population 1,852	Deficiency
Entire Park System	5 to 20	243.0	9.3 to 37	none
Community Parks	5 to 8	7.2	9.3 to 14.8	none
Mini-Parks	.25 to .5	0.3	.5 to 1	slight
Natural Resource Areas	Variable	173.0	1.9 to 3.7	none
Special Use Facilities	Variable	32.6	Variable	none
School Facilities	Variable	30	Variable	none

ACCESSIBILITY

Creating a park system that is safe, accessible, and usable to all individuals, including those with disabilities, is essential. A grading system has been developed by the Michigan Department of Natural Resources (MDNR) to simply and effectively rate parks and facilities on their ease of use and accessibility for handicapped residents, based on the American Disabilities Act (ADA) guidelines. The accessibility grading system uses a five-point system ranging from one (none of the facilities/park areas meet accessibility guidelines), to five (the entire park was developed/renovated using the principles of universal design). (See the table below).

MDNR Accessibility Grading System for Parks and Recreational Facilities	
Accessibility Grade	Definition
1	None of the facilities/park areas meet accessibility guidelines.
2	Some of the facilities/park areas meet accessibility guidelines.
3	Most of the facilities/park areas meet accessibility guidelines.
4	The entire park meets accessibility guidelines.
5	The entire park was developed/renovated using the principles of universal design.

The Village of Lawton is dedicated to improving accessibility at each of its parks when improvements are made. This includes accessible parking, paths, restrooms, activity areas, amenities, and signage. As noted in the inventory listing, Lawton’s parks do not meet all criteria for accessibility to the disabled. The Village of Lawton is committed to improving the accessibility of its facilities and is considering a variety of options to make this possible at its many varied park and recreational facility locations.

COMMUNITY DEMOGRAPHICS

The Village of Lawton’s Parks and Recreation facilities not only serve the Village residents but also residents of the Greater Lawton Area. While the Village of Lawton is located in the Township of Antwerp, Van Buren County, the greater Lawton Area is comprised of the Village of Lawton, Antwerp Township, and neighboring Porter Township.

The table below shows the population of each Census since 1980 for the three municipalities as well as Van Buren County. As of the 2010 Census, the Village of Lawton had a total population of 1,900 people. While this was a small increase from the population at the 2000 Census, it still represents a 22% increase since 1980.

Population Trends - 1980 to 2010					
	1980	1990	2000	2010	% change since 1980
Village of Lawton	1558	1685	1859	1900	22%
Antwerp Township	7744	9293	10813	12182	57%
Porter Township	3857	3857	2406	3798	-2%
Van Buren County	66,814	70060	76263	76258	14%
Totals	79,973	84,895	91,341	94,138	18%

In 2010, the median age in the village was 38.9 years. 25.4% of residents were under the age of 18; 7.6% were between the ages of 18 and 24; 24.5% were from 25 to 44; 23.1% were from 45 to 64; and 19.2% were 65 years of age or older. The gender makeup of the village was 45.1% male and 54.9% female. The spread of population based on age is important to take account of because each age group

has different recreational needs and it is important to provide an opportunity for all ages, especially in a community in which all age groups are near equally represented.

The 2010 Census revealed that there were 730 households, of which 35.2% had children under the age of 18 living with them, 40.8% were married couples living together, 16.4% had a female householder with no husband present, 5.3% had a male householder with no wife present, and 37.4% were non-families.

The median property value in Lawton, MI was \$101,000 in 2018, which is 0.44 times smaller than the national average of \$229,700. Between 2017 and 2018 the median property value increased from \$98,100 to \$101,000, a 2.96% increase. People in Lawton, MI have an average commute time of 22.2 minutes, and they commute by driving alone. Car ownership in Lawton, MI is approximately the same as the national average, with an average of 2 cars per household.

Within the Village of Lawton, over 33% of households are renter occupied. Renters often have less of an opportunity to provide their families with recreation as they are limited in the amount of household improvements they can make. It is important for those who are in rental situations to be provided with adequate opportunities for outdoor recreation.

Communities with high instances of poverty is one that should have a focus on creating low-cost recreation opportunities for families. While Van Buren County has an estimated 19% of the population living below the poverty level (based on the 2013 American Community Survey 5-Year Estimate), in Lawton 10.1% of persons are below the poverty level, and that rises to 12% for children under 18.

GOALS AND OBJECTIVES

Developing goals and objectives is an important part of the recreation planning process. The overall goal of a parks and recreation department is to provide recreation opportunities for the community it serves. More specific goals must be based on the demographic characteristics of the population served, the physical and environmental characteristics of the area, and the input of the community.

Goals provide overarching and general ideas of the desires and needs of community members in relation to their parks. Objectives carry out

the purpose of these goals. The action plan, is the most specific level of planning and it identifies specific projects and programs.

An overall guide for the recreation goals for the Village of Lawton will be to focus efforts on developing additional programs and recreational opportunities within the community; leveraging development and maintenance efforts by pursuing partnerships, grant funding, and volunteer efforts when appropriate.

The goals and objectives were developed through the Village Council and Administration and incorporate recreation planning best practices and the results of the public input process. The following goals and objectives are numbered for identification purposes only. Each goal is considered to carry an equal degree of importance.

Goal 1: To create a broad range of opportunities within Lawton Village Park for all segments of the community, including accessible facilities.

- Establish new park programs for community and visitors (movie night, outdoor music, outdoor classrooms).
- Ensure ADA accessible routes are compliant with current guidelines; develop and enhance internal walking routes within the park.

Goal 2: To provide more programs and other forms of recreation for the youth of the village.

- Develop facilities for multi-generational uses.
- Continue to evaluate unmet recreation needs and recommend various programs in line with current trends.
- Build upon volunteer organizations with park maintenance and program oversight.
- Promote non-motorized transportation throughout the village.

Goal 3: To take advantage of the recreational and economic opportunities presented by new downtown and commercial development.

- Develop property for public access and strong connections to downtown.
- Upgrade deteriorating facilities
- Develop key non-motorized connections within the community.

Goal 4: Develop Non-Motorized Facilities. There are several reasons for promoting and improving non-motorized connections within the Village of Lawton, including but not limited to:

- Encouraging Active Living. Health studies continue to show the impact of an active lifestyle improving quality of life for all ages and abilities. By providing more ways to get out and walk or bike to destinations, it will benefit the residents of Lawton.
- Maintain Community Character. Lawton is primarily a residential community. The more people can walk into town and stay connected with each other, the longer the rural nature of the community will be intact. This also extends to maintaining the business that is in the village; the more people are able to access a local business versus driving into the next town will encourage the local economy. A walkable community such as Lawton will attract tourism and residents to the degree it can provide access to local recreation as well as be a portal to regional attractions.
- With increased traffic and programming in Lawton, the community could increase its appeal to visitors and tourism.

ACTION PLAN

ACTION PLAN LIST			
Land Acquisition Priorities			
Chancy Lewis Entrance to expand driveway			
Downtown property for recreational expansion			
Project Priorities			
	High Priority	Medium Priority	Low Priority
Cannon Park	New benches and trash receptacles	Construct Gazebo	
Chancy Lewis Park	Pickleball Courts Fence along M-40 sidewalk Improve restroom facilities Tree Trimming Create user fees and other revenue sources from park rentals	Investigate ways to improve safety and security Sight lighting	Increase parking
Village Conservation Area		Improve trails	
Stephays Sports Complex	Upgraded facilities	Trail linkages	
Pathways / Trails	Establish a Committee to Master Plan Community Trail Project	Create trail system links to other regional trails	
Other Needs & Desires	Downtown Common Space, a year-round flexible space that will allow for passive recreation, music events, dining, and public gathering Facilitate participation in regional park and recreation projects Upgrade all park facilities to meet handicap accessibility requirements, using universal design principal where possible.		

CONCLUSION

In an effort to provide quality recreational opportunities for its citizens, the Village of Lawton has developed this recreation plan as a tool to guide the development of park and recreational facilities over the next five years. This Plan represents its ongoing commitment by the Village to establish recreational goals and objectives for the community. The Plan will also provide the Village of Lawton eligibility for grants from the Department of Natural Resources to assist the community in reaching its recreational goals.

Community input was collected via an online survey conducted in December of 2020. The results were reviewed and existing goals and objectives for parks and recreation and updated them as needed based upon the existing information and the community input. Then, action plan items that would work toward accomplishing the goals and objectives were developed and prioritized.

The consultant completed the draft Recreation Master Plan document. The draft plan was made available for review at the Lawton Village Hall and on the Lawton Village website beginning on December 23, 2020.

This reviewing opportunity was advertised in the *Courier Leader* and the Village Newsletter. The final opportunity for community input occurred at the advertised public meeting held prior to adoption of the plan. This meeting was held on January 26, 2020 virtually from the Lawton Village Hall.

On January 26, 2020, the Lawton Village Council passed a resolution adopting the Recreation Plan. Copies of the advertisements and resolutions are included in Appendix.

Q1 Please indicate where you live

Answered: 236 Skipped: 0

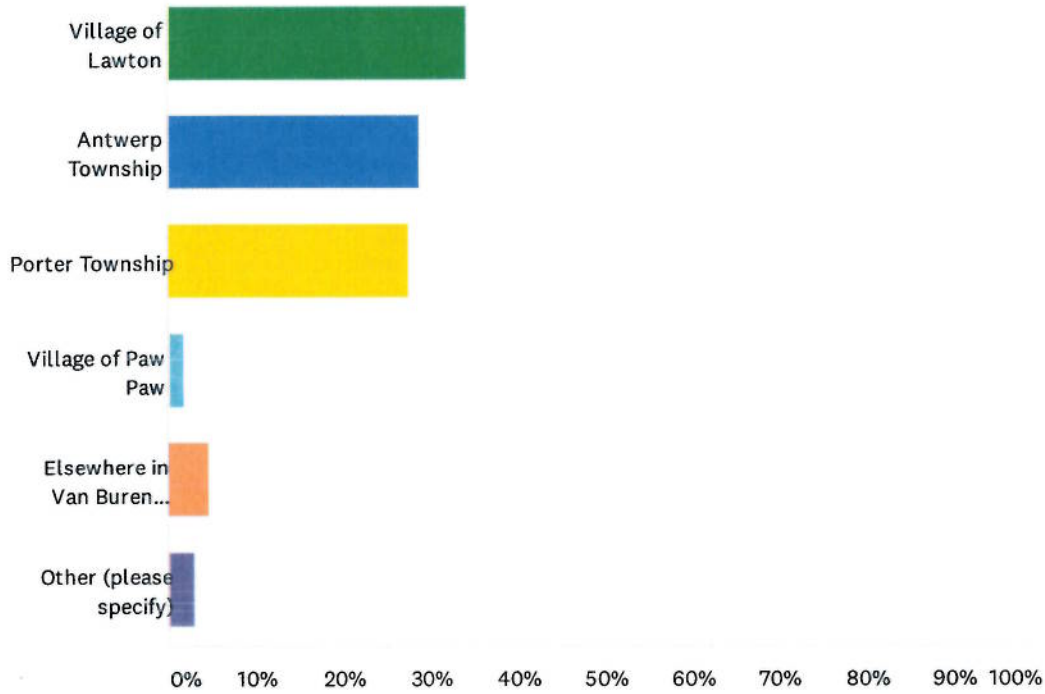

ANSWER CHOICES

- Village of Lawton (1)
- Antwerp Township (2)
- Porter Township (3)
- Village of Paw Paw (4)
- Elsewhere in Van Buren County (5)
- Other (please specify) (6)

RESPONSES

Village of Lawton (1)	34.32%	81
Antwerp Township (2)	28.81%	68
Porter Township (3)	27.54%	65
Village of Paw Paw (4)	1.69%	4
Elsewhere in Van Buren County (5)	4.66%	11
Other (please specify) (6)	2.97%	7

TOTAL

236

BASIC STATISTICS

Minimum	Maximum	Median	Mean	Standard Deviation
1.00	6.00	2.00	2.22	1.24

#	OTHER (PLEASE SPECIFY)	DATE
1	Kalamazoo County	12/17/2020 9:07 AM
2	Business in Village	12/16/2020 10:00 AM
3	Grand Rapids but former Porter township resident	12/15/2020 9:06 PM
4	Kalamazoo	12/15/2020 8:20 PM
5	portage, kalamazoo	12/15/2020 2:52 PM
6	City of Kalamazoo	12/15/2020 12:57 PM
7	Paw paw township	12/15/2020 11:27 AM

Q2 What is your age?

Answered: 236 Skipped: 0

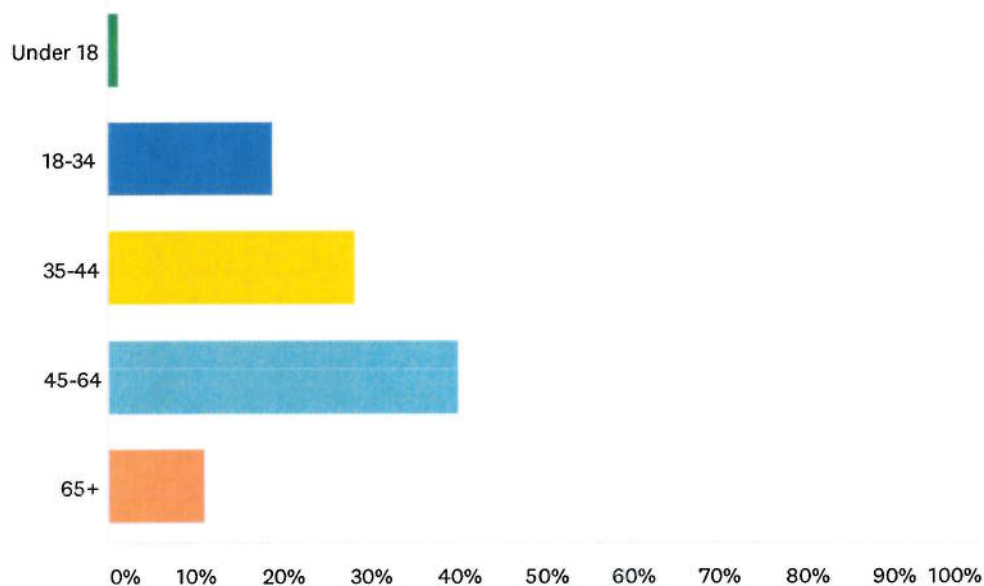

ANSWER CHOICES

- Under 18 (1)
- 18-34 (2)
- 35-44 (3)
- 45-64 (4)
- 65+ (5)
- TOTAL

RESPONSES

Under 18 (1)	1.27%	3
18-34 (2)	19.07%	45
35-44 (3)	28.39%	67
45-64 (4)	40.25%	95
65+ (5)	11.02%	26
TOTAL		236

BASIC STATISTICS

Minimum	Maximum	Median	Mean	Standard Deviation
1.00	5.00	4.00	3.41	0.96

Q3 What do you typically do in Village of Lawton parks? (select all that apply)

Answered: 236 Skipped: 0

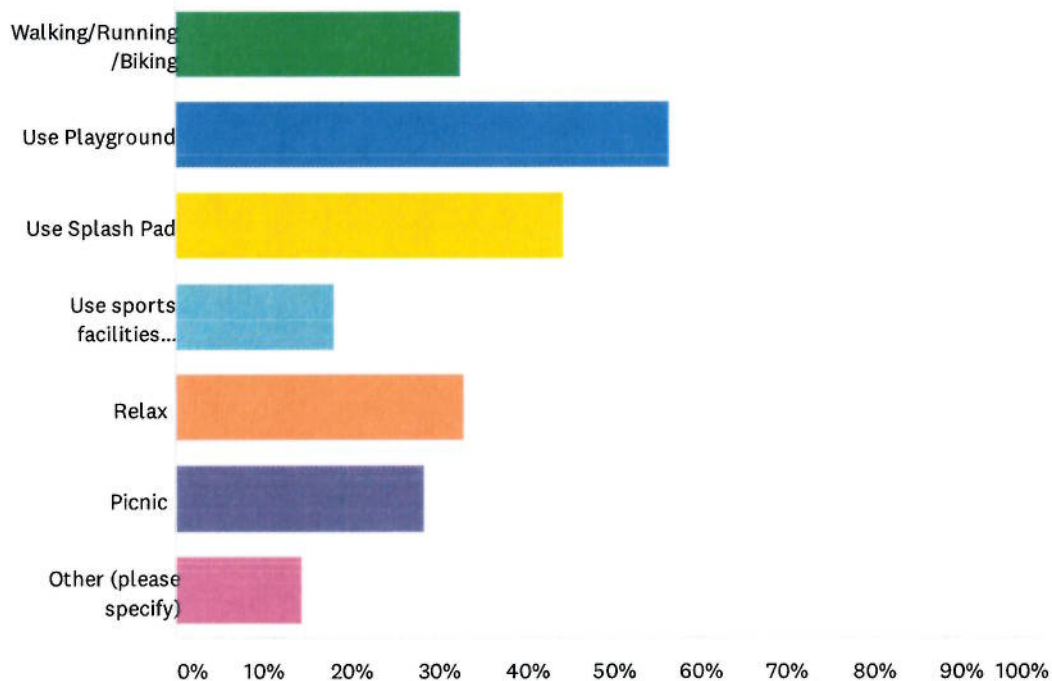

ANSWER CHOICES

RESPONSES

Walking/Running/Biking (1)	32.63%	77
Use Playground (2)	56.78%	134
Use Splash Pad (3)	44.49%	105
Use sports facilities (baseball, football, basketball, etc) (4)	18.22%	43
Relax (5)	33.05%	78
Picnic (6)	28.39%	67
Other (please specify) (7)	14.41%	34

Total Respondents: 236

BASIC STATISTICS

Minimum	Maximum	Median	Mean	Standard Deviation
1.00	7.00	3.00	3.46	1.84

#	OTHER (PLEASE SPECIFY)	DATE
1	Place to let dogs off leash	12/23/2020 10:56 AM
2	Tennis	12/23/2020 10:14 AM
3	NEw to area so haven't usedany	12/23/2020 9:39 AM
4	Look forward to using splash pad	12/20/2020 5:48 PM
5	we used to play tennis, but the courts need work	12/18/2020 1:40 PM
6	Don't use your park.	12/18/2020 9:49 AM
7	We don't use the park much...teenagers smoking and cussing	12/18/2020 9:13 AM
8	WORK	12/18/2020 8:39 AM
9	Don't use it	12/16/2020 11:39 PM
10	Nothing	12/16/2020 12:20 PM
11	Waiting for Covid to get under control	12/16/2020 11:53 AM
12	nothing	12/16/2020 10:00 AM
13	we don't use the parks	12/16/2020 9:14 AM
14	Lawton Bootcamp indoor facility	12/16/2020 12:04 AM
15	I would walk if we had a trail!	12/15/2020 10:05 PM
16	Meet with students & families for learning activities during COVID-19- prior did not use park	12/15/2020 10:00 PM
17	Na	12/15/2020 10:00 PM
18	Not much to do	12/15/2020 9:24 PM
19	Going to big T	12/15/2020 7:24 PM
20	watch grandkids play	12/15/2020 4:17 PM
21	I don't use the parks	12/15/2020 4:14 PM
22	Nothing	12/15/2020 3:31 PM
23	Kids used to use park but have outgrown	12/15/2020 2:52 PM
24	nothing	12/15/2020 2:35 PM
25	just moving into to Lawton so really haven't used any yet	12/15/2020 2:18 PM
26	Farmer's Market	12/15/2020 1:46 PM
27	Don't use often.	12/15/2020 1:08 PM
28	I am not extremely familiar with Lawton's parks at this time. Though, my main uses of parks near me are shown above.	12/15/2020 12:57 PM
29	Work	12/15/2020 12:23 PM
30	My grand kids use it.	12/15/2020 12:04 PM
31	Grandkids	12/15/2020 12:01 PM
32	Pavillion Party	12/15/2020 11:53 AM
33	Family get togethes at the pavilions	12/14/2020 8:01 PM
34	Birthday party.	12/14/2020 6:31 PM

Q4 Who in your household is the most active user of our parks?

Answered: 236 Skipped: 0

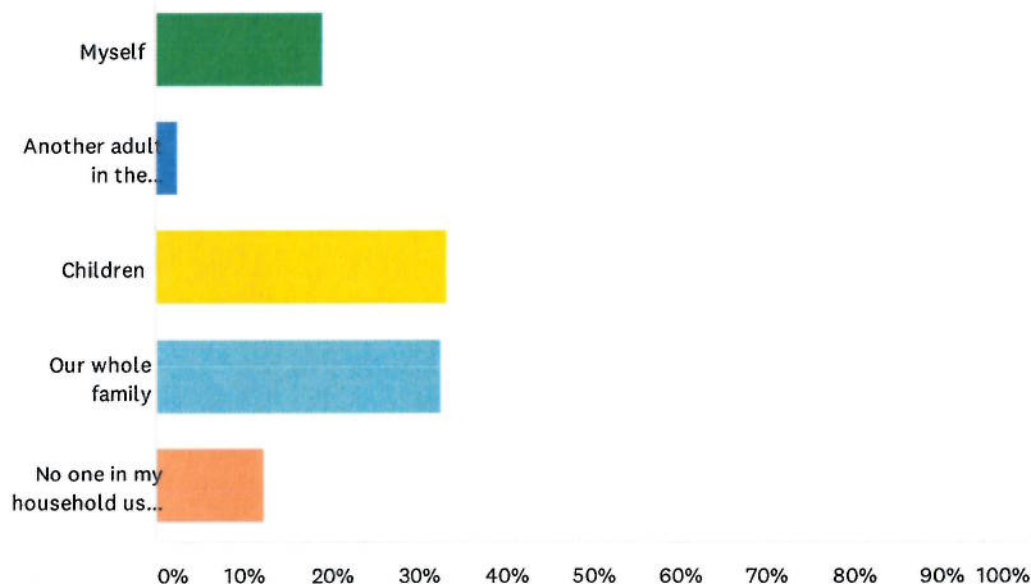

ANSWER CHOICES

- Myself (1)
- Another adult in the household (2)
- Children (3)
- Our whole family (4)
- No one in my household uses parks (5)

RESPONSES

19.07%	45
2.54%	6
33.47%	79
32.63%	77
12.29%	29

TOTAL

236

BASIC STATISTICS

Minimum	Maximum	Median	Mean	Standard Deviation
1.00	5.00	3.00	3.17	1.26

Q5 How important are parks, trails, and open space to you and/or your household's quality of life?

Answered: 236 Skipped: 0

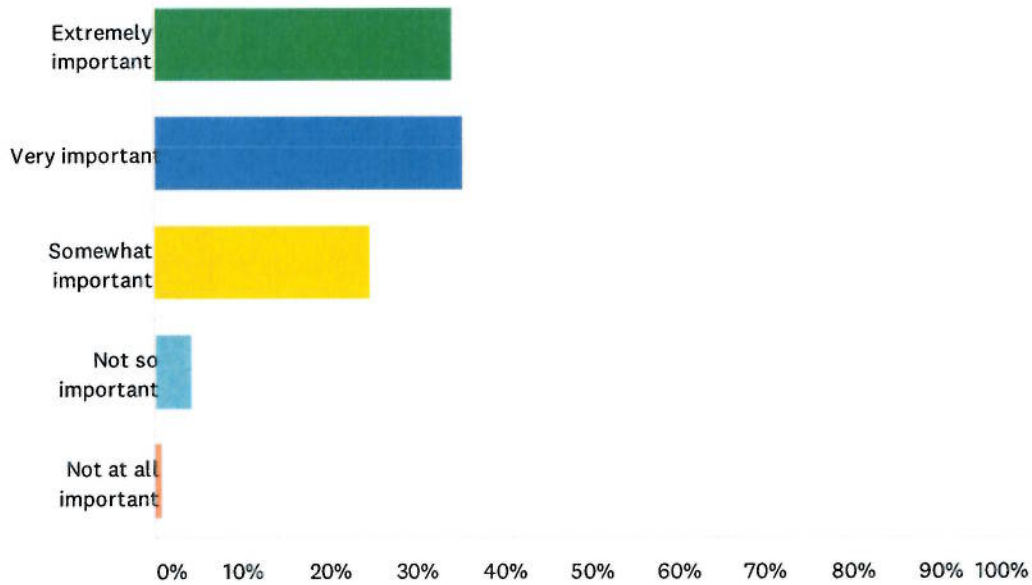

ANSWER CHOICES

RESPONSES

Extremely important (1)	34.32%	81
Very important (2)	35.59%	84
Somewhat important (3)	25.00%	59
Not so important (4)	4.24%	10
Not at all important (5)	0.85%	2
TOTAL		236

BASIC STATISTICS

Minimum	Maximum	Median	Mean	Standard Deviation
1.00	5.00	2.00	2.02	0.92

Q6 Have you noticed any physical (or other) obstacles to accessing or enjoying the parks?

Answered: 233 Skipped: 3

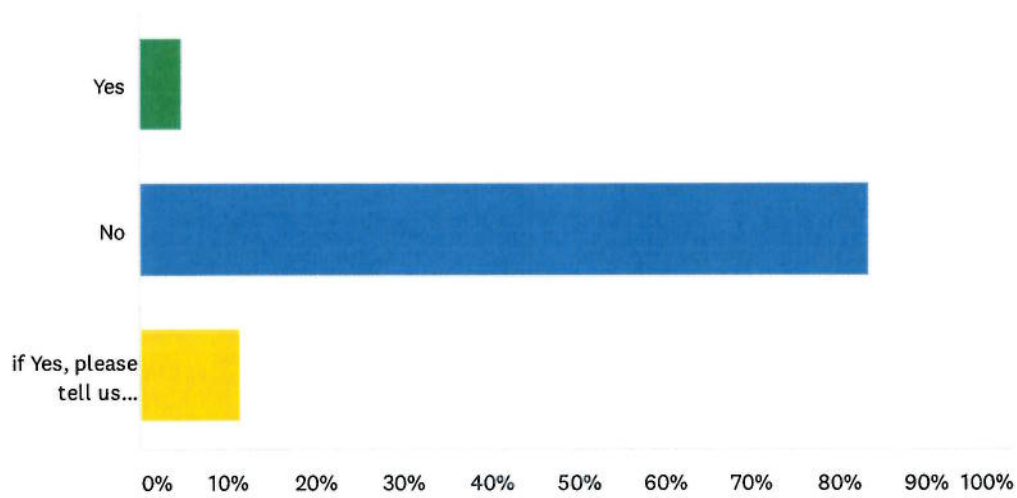

ANSWER CHOICES

- Yes (1)
- No (2)
- if Yes, please tell us... (3)

RESPONSES

Yes (1)	4.72%	11
No (2)	83.69%	195
if Yes, please tell us... (3)	11.59%	27

TOTAL

233

BASIC STATISTICS

Minimum	Maximum	Median	Mean	Standard Deviation
1.00	3.00	2.00	2.07	0.40

#	IF YES, PLEASE TELL US...	DATE
1	Covid 19	12/23/2020 12:26 PM
2	Smoking and cussing teenagers being rude	12/18/2020 9:13 AM
3	They are small, parking is limited, I don't know where they all are. Mostly I am aware of the Chancy Lewis Park.	12/18/2020 8:39 AM
4	Broken nets	12/18/2020 7:37 AM
5	possibly more prominently mentioned on Lawton's web site	12/17/2020 9:07 AM
6	Teenagers smoking in front of children	12/16/2020 8:27 PM
7	Graffiti,	12/16/2020 11:45 AM
8	Too far from town	12/15/2020 10:01 PM
9	Traffic / parking	12/15/2020 7:20 PM
10	Parking	12/15/2020 5:41 PM
11	big kids are rude	12/15/2020 3:12 PM
12	I think all of the signage regarding NO ____ is off putting. I realize there must be rules, and I don't want the parks abused or to encounter abusive people, but the signs seem offensive.	12/15/2020 2:53 PM
13	Cleanliness	12/15/2020 2:47 PM
14	Sometimes when we visit the playground there are older kids there that make it inappropriate for younger children.	12/15/2020 2:45 PM
15	Narrow driveway to the park	12/15/2020 2:31 PM
16	Riff Raff that hangs out at the park and defaces the property.	12/15/2020 2:28 PM
17	Teenagers being on the playground making out while young children are trying to play.	12/15/2020 2:15 PM
18	Handicapped parking at park	12/15/2020 2:15 PM
19	traffic speed on M40	12/15/2020 12:59 PM
20	mosquitos and poison ivy in kids dream	12/15/2020 12:59 PM
21	Speedy M40	12/15/2020 12:16 PM
22	We don't go to kids dream. It's over ran with older kids saying and doing inappropriate things.	12/15/2020 12:05 PM
23	Parking	12/15/2020 11:49 AM
24	Need to add topsoil along sidewalk from rest room to fountain, and seed for grass	12/15/2020 11:38 AM
25	Teens should have another place to go not near the young kids. Too many drugs and vaping being done there	12/15/2020 11:31 AM
26	The playground is dark and hold a lots of moisture	12/10/2020 6:22 PM
27	Too many trees over playground area	12/9/2020 8:21 PM

Q7 There are many ideas about improving our parks system. Please indicate your preferences for the following list and rate their importance

Answered: 236 Skipped: 0

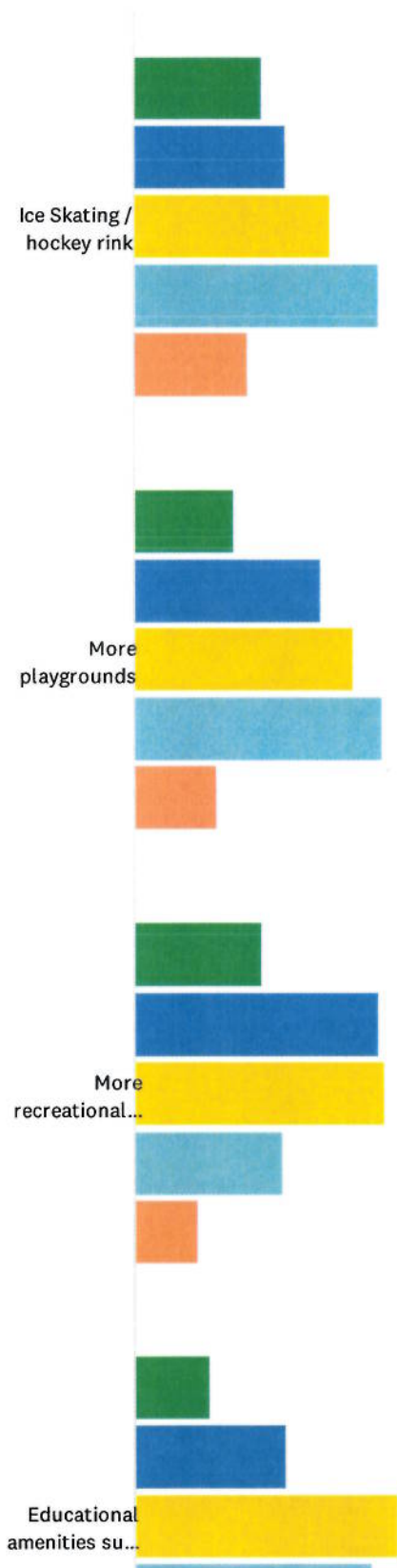

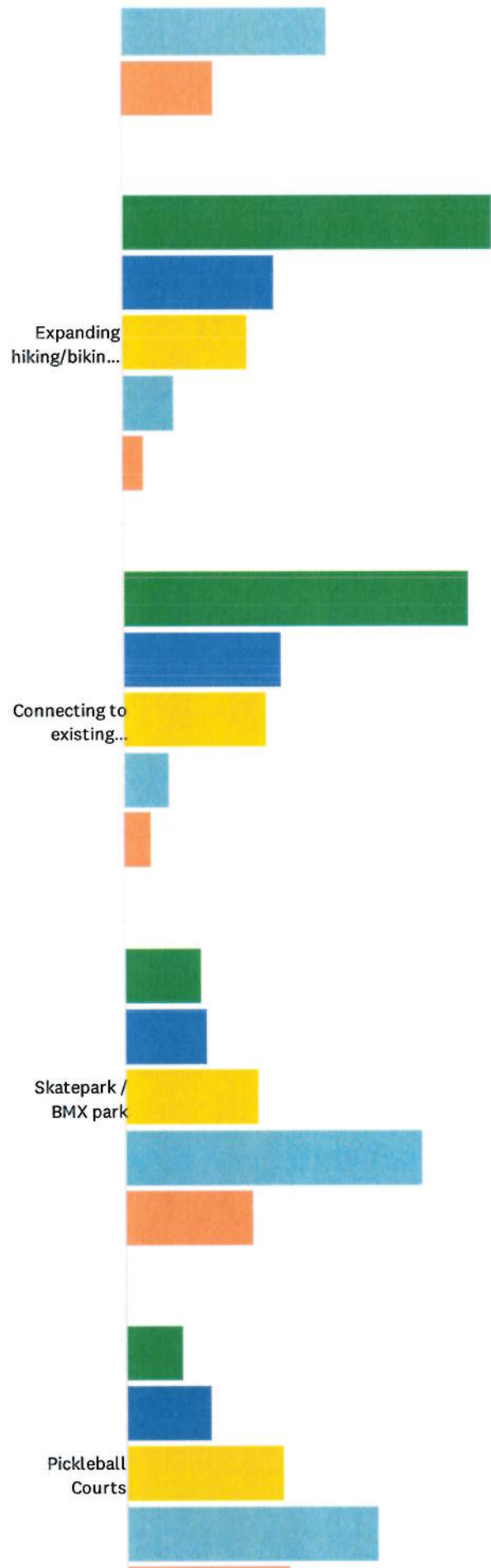

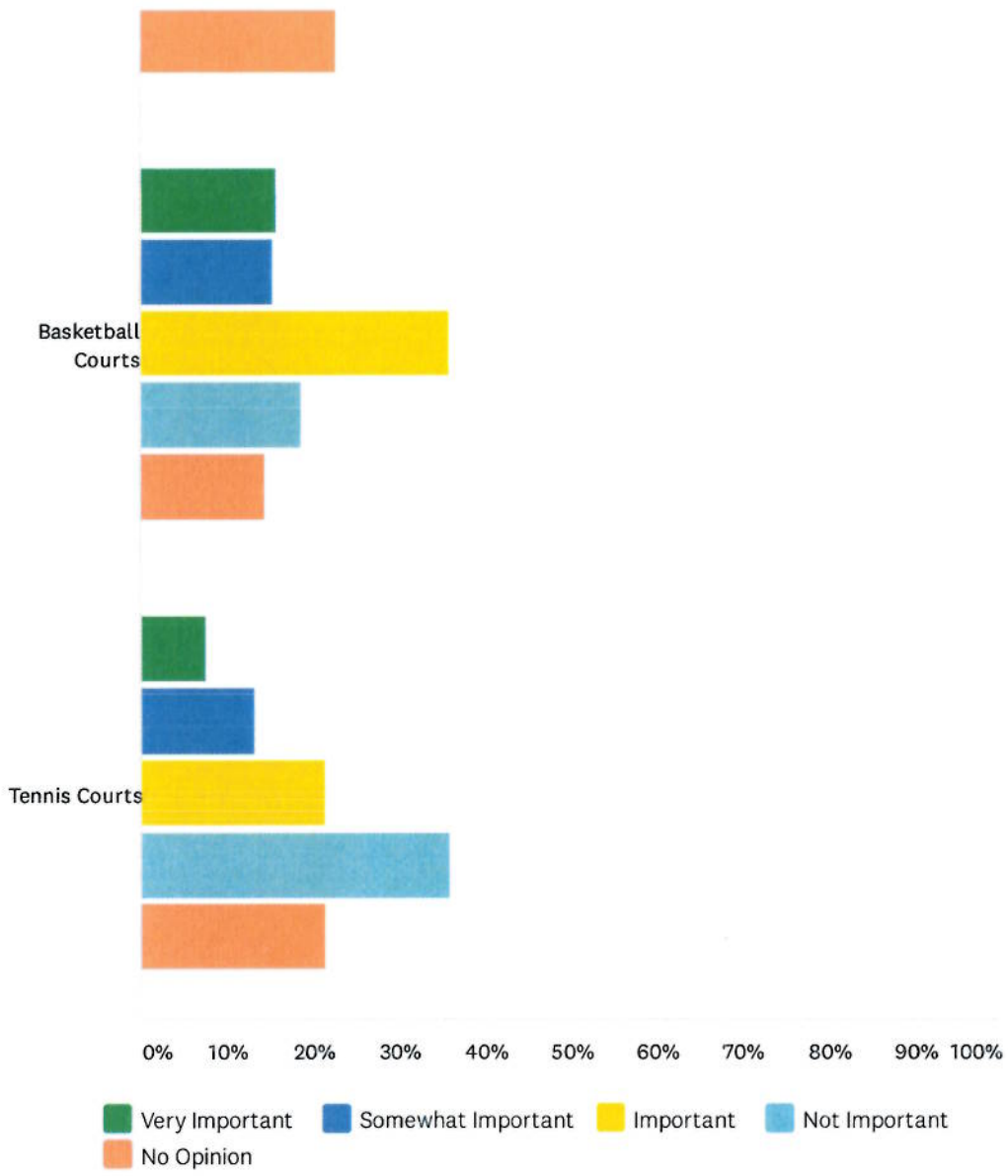

	VERY IMPORTANT (1)	SOMEWHAT IMPORTANT (2)	IMPORTANT (3)	NOT IMPORTANT (4)	NO OPINION (5)	TOTAL	WEIGHTED AVERAGE
Ice Skating / hockey rink	15.25% 36	18.22% 43	23.73% 56	29.24% 69	13.56% 32	236	3.08
More playgrounds	11.86% 28	22.46% 53	26.27% 62	29.66% 70	9.75% 23	236	3.03
More recreational equipment such as shuffleboard, playground amenities, etc.	15.25% 36	29.24% 69	30.08% 71	17.80% 42	7.63% 18	236	2.73
Educational amenities such as tree identification plaques	8.90% 21	18.22% 43	31.78% 75	28.39% 67	12.71% 30	236	3.18
Expanding hiking/biking trail network	51.27% 121	21.19% 50	17.37% 41	7.20% 17	2.97% 7	236	1.89
Connecting to existing hiking/biking trail networks	47.88% 113	22.03% 52	19.92% 47	6.36% 15	3.81% 9	236	1.96
Skatepark / BMX park	10.59% 25	11.44% 27	18.64% 44	41.53% 98	17.80% 42	236	3.44
Pickleball Courts	8.05% 19	11.86% 28	22.03% 52	35.17% 83	22.88% 54	236	3.53
Basketball Courts	15.68% 37	15.25% 36	36.02% 85	18.64% 44	14.41% 34	236	3.01
Tennis Courts	7.63% 18	13.14% 31	21.61% 51	36.02% 85	21.61% 51	236	3.51

BASIC STATISTICS

	MINIMUM	MAXIMUM	MEDIAN	MEAN	STANDARD DEVIATION
Ice Skating / hockey rink	1.00	5.00	3.00	3.08	1.27
More playgrounds	1.00	5.00	3.00	3.03	1.18
More recreational equipment such as shuffleboard, playground amenities, etc.	1.00	5.00	3.00	2.73	1.15
Educational amenities such as tree identification plaques	1.00	5.00	3.00	3.18	1.14
Expanding hiking/biking trail network	1.00	5.00	1.00	1.89	1.11
Connecting to existing hiking/biking trail networks	1.00	5.00	2.00	1.96	1.13
Skatepark / BMX park	1.00	5.00	4.00	3.44	1.21
Pickleball Courts	1.00	5.00	4.00	3.53	1.19
Basketball Courts	1.00	5.00	3.00	3.01	1.24
Tennis Courts	1.00	5.00	4.00	3.51	1.18

#	OTHER (PLEASE SPECIFY)	DATE
1	walking trails with pets	12/21/2020 9:29 PM
2	A safe area for kids to ride bikes/scooters	12/16/2020 8:34 AM
3	Toddler park	12/15/2020 8:51 PM
4	Place to ride ATV	12/15/2020 4:38 PM
5	Encouragement for pet owners to visit designated animal-friendly areas. Education about how tax dollars support and maintain parks - even info on the relevant yearly budgets and if/how they've changed. Personally, I think it's important that people make the connection between taxes and positive, successful initiatives that directly improve residents' quality of life.	12/15/2020 3:45 PM
6	I would like to see work out stations on trails	12/15/2020 3:07 PM
7	A park/playground area in the actual "heart" of the residential area of the Village would be GREAT! Also, a band shell or covered stage area/amphitheatre for future concerts, stage plays/dramas/cultural activities - with potential for lighting and sound - would be extremely positive and a great addition to our park/Village.	12/15/2020 2:53 PM
8	Great to get more varied options for teens and adults that are healthy and constructive! We have good play equipment and basketball areas between schools and Kids Dream already!	12/15/2020 2:52 PM
9	Golf cart trails	12/15/2020 1:11 PM
10	ice hockey that is floor hockey in summer!	12/15/2020 12:59 PM
11	Adding pickleball and shuffleboard may seem boring but it adds a more well rounded age participation in our parks. A tennis court can double for pickleball, just add color specific lines. Adding a shuffleboard pad might be the most cost effective addition that gets used.	12/15/2020 12:12 PM
12	These extra things will are only worthwhile if they are maintained by public works and controlled with police presence. I don't have much faith in public works taking on more responsibilities.	12/15/2020 12:05 PM
13	Upgrade rest rooms, and develop better horse shoe pits.	12/15/2020 11:38 AM
14	Basketball Courts and Baseball fields need improvement	12/9/2020 10:38 AM

Q8 How often do you and your family use the following parks and recreation facilities? mark only one oval per row

Answered: 236 Skipped: 0

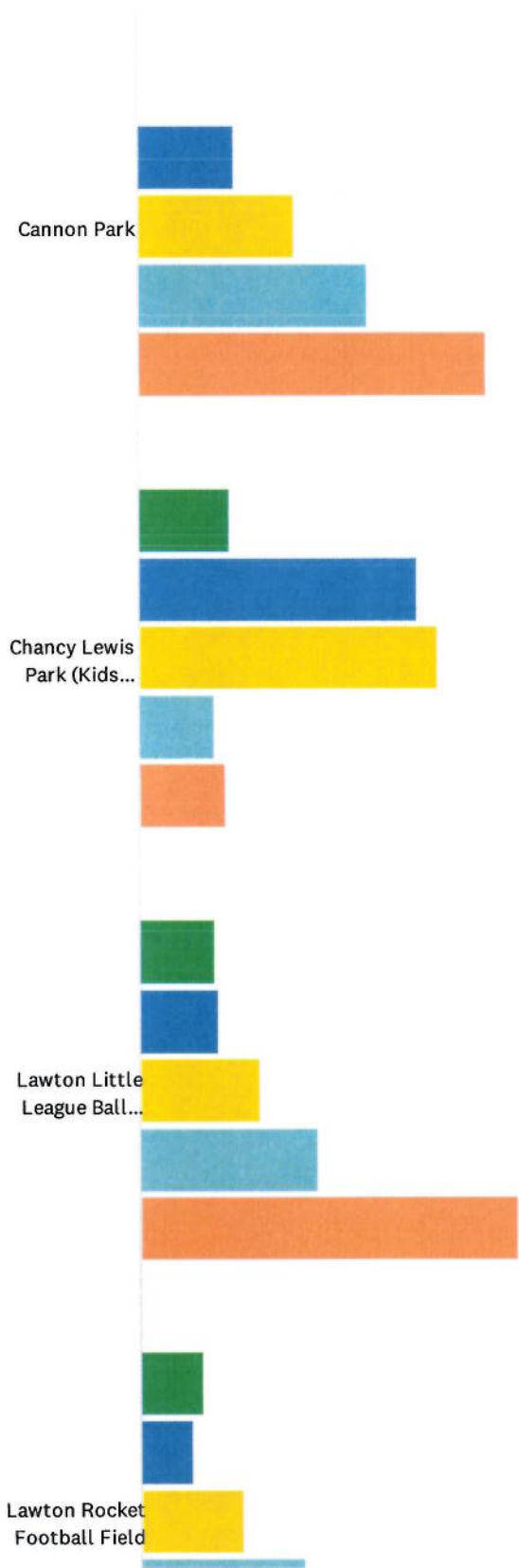

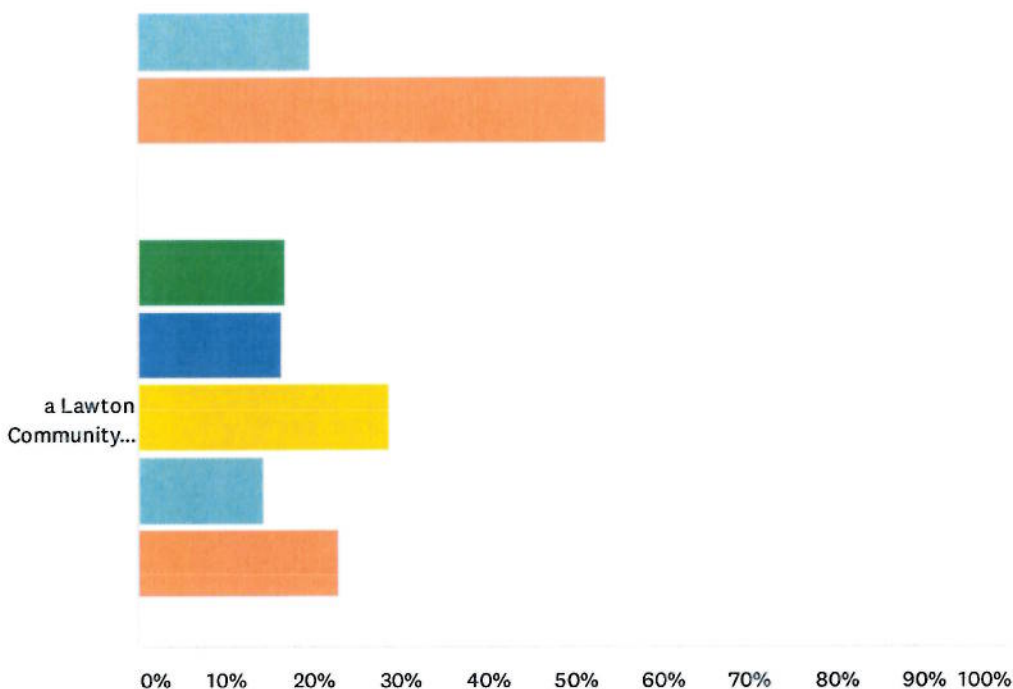

■ Frequently (once a week or more)
 ■ Often (2 - 3 times a month)
 ■ Sometimes (a few times each year)
 ■ Rarely (less than once a year)
 ■ Never

	FREQUENTLY (ONCE A WEEK OR MORE) (1)	OFTEN (2 - 3 TIMES A MONTH) (2)	SOMETIMES (A FEW TIMES EACH YEAR) (3)	RARELY(LESS THAN ONCE A YEAR) (4)	NEVER (5)	TOTAL	WEIGHTED AVERAGE
Cannon Park	0.00% 0	11.40% 26	18.86% 43	27.63% 63	42.11% 96	228	4.00
Chancy Lewis Park (Kids Dream Playground/Splash Pad/Pavilions/Basketball and Tennis Courts)	10.78% 25	33.62% 78	36.21% 84	9.05% 21	10.34% 24	232	2.75
Lawton Little League Ball Diamonds	8.90% 21	9.32% 22	14.41% 34	21.61% 51	45.76% 108	236	3.86
Lawton Rocket Football Field	7.63% 18	6.36% 15	12.29% 29	19.92% 47	53.81% 127	236	4.06
a Lawton Community Schools recreation field/facility	17.02% 40	16.60% 39	28.94% 68	14.47% 34	22.98% 54	235	3.10

BASIC STATISTICS

	MINIMUM	MAXIMUM	MEDIAN	MEAN	STANDARD DEVIATION
Cannon Park	2.00	5.00	4.00	4.00	1.03
Chancy Lewis Park (Kids Dream Playground/Splash Pad/Pavilions/Basketball and Tennis Courts)	1.00	5.00	3.00	2.75	1.10
Lawton Little League Ball Diamonds	1.00	5.00	4.00	3.86	1.33
Lawton Rocket Football Field	1.00	5.00	5.00	4.06	1.26
a Lawton Community Schools recreation field/facility	1.00	5.00	3.00	3.10	1.38

#	OTHER (PLEASE SPECIFY)	DATE
1	cross country trail for walking	12/21/2020 9:29 PM
2	I walk the sidewalks of the village.	12/18/2020 8:39 AM
3	Just moved here	12/15/2020 10:12 PM
4	Often spectators	12/15/2020 5:41 PM
5	During sports seasons, the ball fields are most important	12/15/2020 3:41 PM
6	didn't know that we could use LCS facilities	12/15/2020 3:39 PM
7	During sports seasons, the ball fields are 100% most important.	12/15/2020 3:07 PM
8	just moved to Lawton	12/15/2020 2:18 PM
9	I use the parks near me atleast once a week for walking, running, biking, softball, skateboarding, etc.	12/15/2020 12:57 PM
10	No idea what/where Cannon Park is?	12/15/2020 12:24 PM

Q9 Which of the following of parks and recreation amenities are the most important to you? (Please select your TOP THREE)

Answered: 236 Skipped: 0

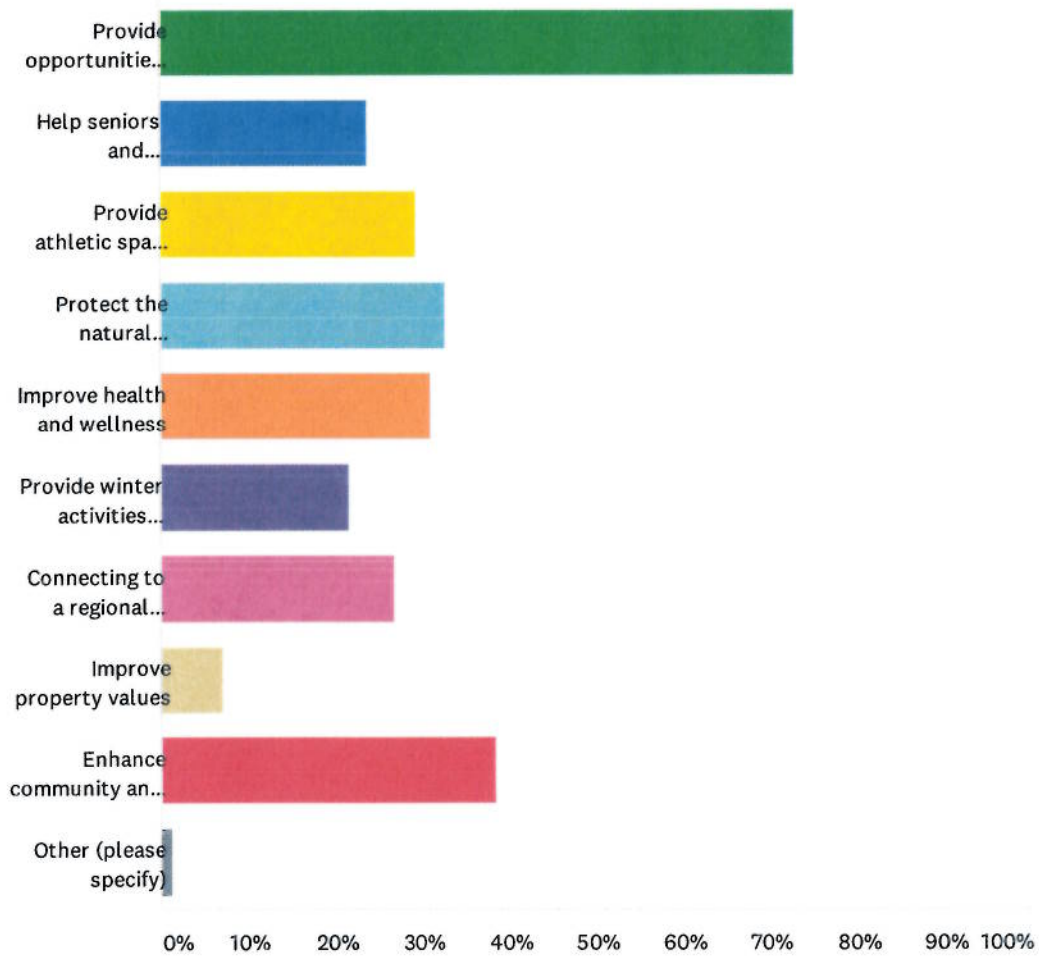

ANSWER CHOICES

RESPONSES

Provide opportunities to enjoy nature/outdoors (1)	72.88%	172
Help seniors and physically-challenged individuals remain active (2)	23.73%	56
Provide athletic space and opportunities (3)	29.24%	69
Protect the natural environment and wildlife (4)	32.63%	77
Improve health and wellness (5)	30.93%	73
Provide winter activities (snowmobiling, cross country skiing, ice skating, etc.) (6)	21.61%	51
Connecting to a regional trail network (7)	26.69%	63
Improve property values (8)	7.20%	17
Enhance community and sense of place (9)	38.56%	91
Other (please specify) (10)	1.27%	3
Total Respondents: 236		

BASIC STATISTICS

Minimum	Maximum	Median	Mean	Standard Deviation
1.00	10.00	4.00	4.31	2.80

#	OTHER (PLEASE SPECIFY)	DATE
1	A place to take my granddaughters when they visit.	12/15/2020 5:33 PM
2	Place to ride ATV	12/15/2020 4:38 PM
3	Na	12/15/2020 3:31 PM

Q10 How important are the following in improving parks and recreation in the Village of Lawton

Answered: 236 Skipped: 0

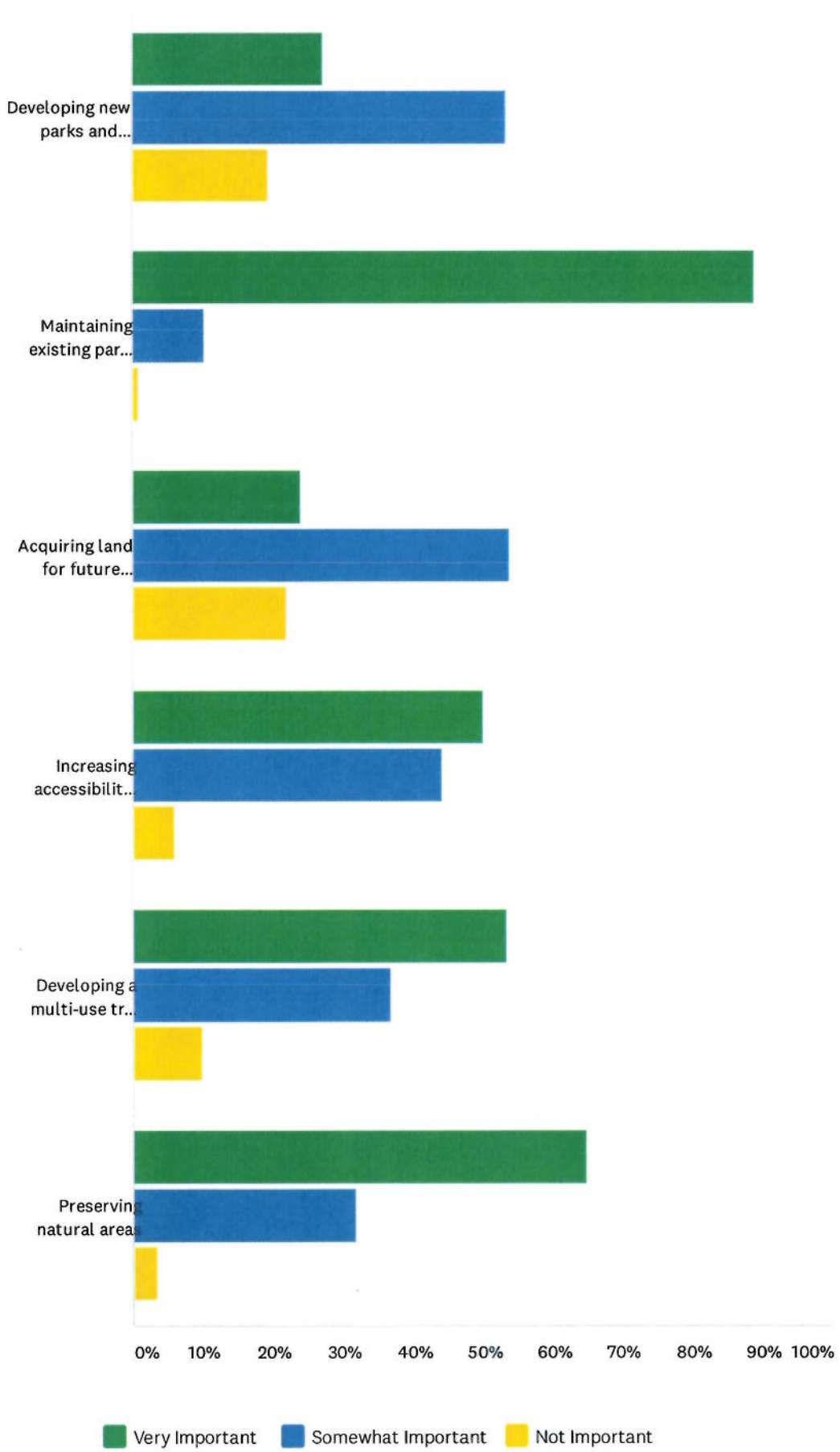

	VERY IMPORTANT (1)	SOMEWHAT IMPORTANT (2)	NOT IMPORTANT (3)	TOTAL	WEIGHTED AVERAGE
Developing new parks and facilities	27.12% 64	53.39% 126	19.49% 46	236	1.92
Maintaining existing parks and facilities	88.98% 210	10.17% 24	0.85% 2	236	1.12
Acquiring land for future parks	24.15% 57	53.81% 127	22.03% 52	236	1.98
Increasing accessibility for all abilities	50.00% 118	44.07% 104	5.93% 14	236	1.56
Developing a multi-use trail system	53.39% 126	36.86% 87	9.75% 23	236	1.56
Preserving natural areas	64.83% 153	31.78% 75	3.39% 8	236	1.39

BASIC STATISTICS

	MINIMUM	MAXIMUM	MEDIAN	MEAN	STANDARD DEVIATION
Developing new parks and facilities	1.00	3.00	2.00	1.92	0.68
Maintaining existing parks and facilities	1.00	3.00	1.00	1.12	0.35
Acquiring land for future parks	1.00	3.00	2.00	1.98	0.68
Increasing accessibility for all abilities	1.00	3.00	1.50	1.56	0.60
Developing a multi-use trail system	1.00	3.00	1.00	1.56	0.66
Preserving natural areas	1.00	3.00	1.00	1.39	0.55

Q11 Which groups do you feel are under-served by current recreation services and amenities? Please check all that apply.

Answered: 236 Skipped: 0

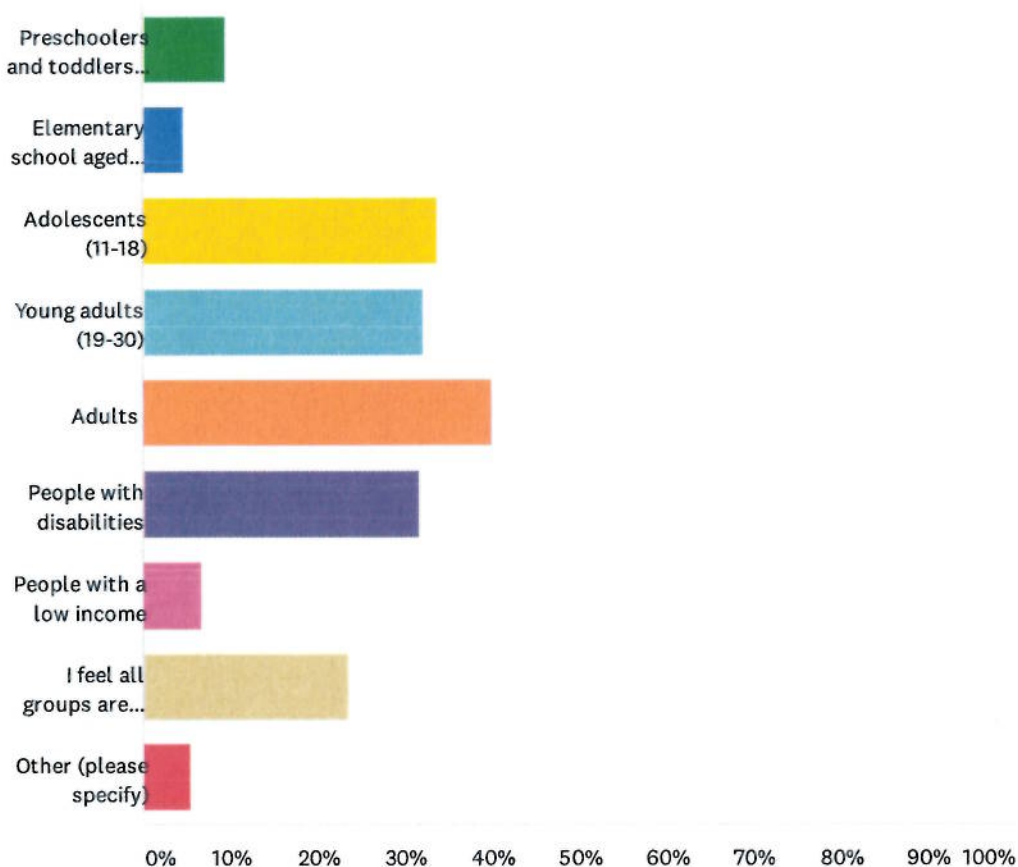

ANSWER CHOICES

RESPONSES

Preschoolers and toddlers (under 5) (1)	9.32%	22
Elementary school aged children (5-10) (2)	4.66%	11
Adolescents (11-18) (3)	33.90%	80
Young adults (19-30) (4)	32.20%	76
Adults (5)	40.25%	95
People with disabilities (6)	31.78%	75
People with a low income (7)	6.78%	16
I feel all groups are adequately served (8)	23.73%	56
Other (please specify) (9)	5.51%	13
Total Respondents: 236		

BASIC STATISTICS

Minimum 1.00	Maximum 9.00	Median 5.00	Mean 4.93	Standard Deviation 1.95
-----------------	-----------------	----------------	--------------	----------------------------

#	OTHER (PLEASE SPECIFY)	DATE
1	undecided	12/17/2020 9:07 AM
2	Older adults	12/16/2020 11:39 PM
3	older folks who would like to be active in a safe environment	12/16/2020 4:36 PM
4	I don't know enough about the parks to answer this.	12/16/2020 9:14 AM
5	Elderly	12/15/2020 11:50 PM
6	ATV riders	12/15/2020 4:38 PM
7	Senior Citizens	12/15/2020 3:39 PM
8	seniors	12/15/2020 2:35 PM
9	no opinion	12/15/2020 2:18 PM
10	elderly	12/15/2020 12:59 PM
11	Not familiar enough to answer accurately.	12/15/2020 12:57 PM
12	I would consider 50+ a group in themselves.	12/15/2020 12:12 PM
13	Sw	12/15/2020 11:27 AM

Q12 How should different types of trails or pathways be prioritized in the Village of Lawton?

Answered: 236 Skipped: 0

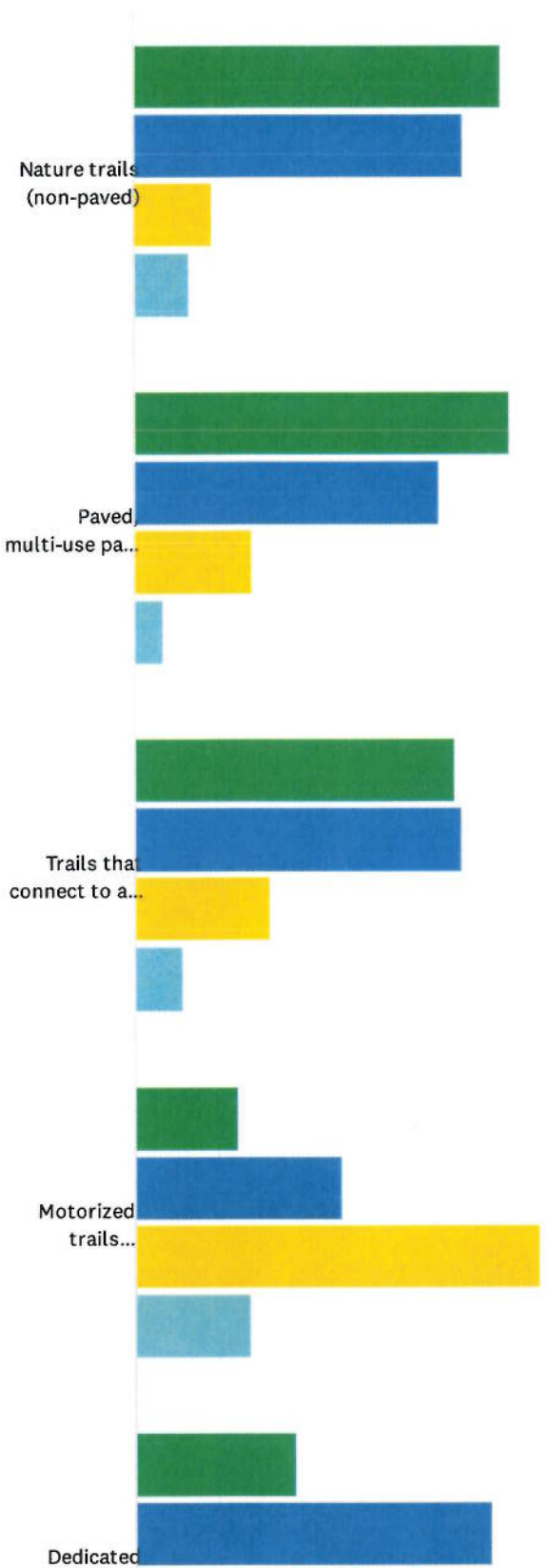

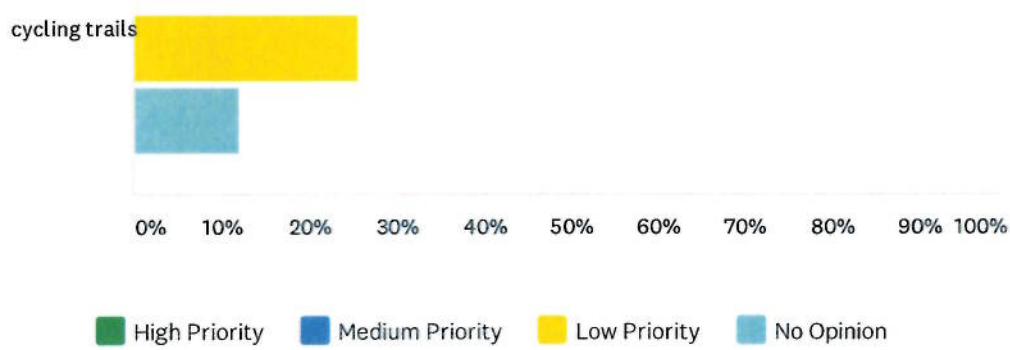

	HIGH PRIORITY (1)	MEDIUM PRIORITY (2)	LOW PRIORITY (3)	NO OPINION (4)	TOTAL	WEIGHTED AVERAGE
Nature trails (non-paved)	44.40% 103	39.66% 92	9.48% 22	6.47% 15	232	1.78
Paved, multi-use paths (bikes, walking, etc.)	45.49% 106	36.91% 86	14.16% 33	3.43% 8	233	1.76
Trails that connect to a regional trail system	38.63% 90	39.48% 92	16.31% 38	5.58% 13	233	1.89
Motorized trails (snowmobile, four wheeler, etc.)	12.45% 29	24.89% 58	48.93% 114	13.73% 32	233	2.64
Dedicated cycling trails	19.23% 45	43.16% 101	25.64% 60	11.97% 28	234	2.30

BASIC STATISTICS

	MINIMUM	MAXIMUM	MEDIAN	MEAN	STANDARD DEVIATION
Nature trails (non-paved)	1.00	4.00	2.00	1.78	0.87
Paved, multi-use paths (bikes, walking, etc.)	1.00	4.00	2.00	1.76	0.82
Trails that connect to a regional trail system	1.00	4.00	2.00	1.89	0.87
Motorized trails (snowmobile, four wheeler, etc.)	1.00	4.00	3.00	2.64	0.87
Dedicated cycling trails	1.00	4.00	2.00	2.30	0.91

#	OTHER (PLEASE SPECIFY)	DATE
1	I see that walking is included with biking. I must disagree with this idea. Bikes and walkers do not mix well. It is unsafe.	12/18/2020 8:39 AM
2	I would use a paved bike system as I uses portages, kalamazoo's and cal haven trail	12/15/2020 2:52 PM

Q13 Please share any other comments regarding parks and recreation in the Village of Lawton.

Answered: 54 Skipped: 182

#	RESPONSES	DATE
1	Alot of people already hang out in the woods where there not supposed to be. More trails might add to that.	12/23/2020 9:42 AM
2	Our family loves the idea of an ice rink. Skating is a lifetime sport and fun for all ages. A skate rental hut could even bring some income in for the community. Sounds like a super fun winter option! We could certainly use more options for winter fun.	12/22/2020 7:41 PM
3	There is nothing to do here. We must have lovely places to play outside and encourage movement for all ages. If we want young families to move here we must offer something for them to do.	12/20/2020 5:48 PM
4	N-A	12/19/2020 6:51 PM
5	None	12/19/2020 10:19 AM
6	Regarding recreation in the Village: the entire village could be considered to be a "recreational facility." I wouldn't call it a park, but it could be 'park-like,' by which my thought is that it could be more conducive to residents and neighbors being better acquainted and more involved. The need for going to small parks dotted around the village might be mitigated if people found park-like settings at their home which may be accessed at a moment's notice, without traffic issues. RE: Chauncy Lewis Park, I find that the need to cross M-40 to get to it from most of the village is not a safe condition for children and other pedestrians.	12/18/2020 8:39 AM
7	Thanks for doing this survey!	12/17/2020 9:07 AM
8	I would like to see the streets in the Village of Lawton all to have pedestrian side walks on both sides of each street. When there are even two or three walkers, going in differing directions on the one side walk that is available, someone has to step out onto the street. If you want the Village to be appealing to possible new residents, they are looking for safe walking conditions for them and for their children throughout the village. There are too many streets without sidewalks both sides of a street. It shouts neglect for the residents, regardless of whether they are using your parks or not. They need safe and pleasurable conditions near to home. Who wants to have to drive everywhere, and to a park especially when they have their own neighborhoods to possible enjoy?	12/16/2020 4:36 PM
9	Think the splash pad is great happy the kids have a fun place to play in the summer !!	12/16/2020 4:33 PM
10	Na	12/16/2020 8:50 AM
11	We LOVE Kids Dream and the splash pad! I have 3 little kids and we go there almost daily! It would be nice to have paved paths/trails somewhere though to go and walk with the kids without having to worry about traffic - some place that is easy to push a stroller and for the young ones to ride bikes.	12/16/2020 8:34 AM
12	We would love to see pickle ball courts that specifically cater to seniors but can be utilized by all ages.	12/16/2020 7:21 AM
13	How does this department share information with the public? I was not aware there was a parks and recreation department until I received this email to take survey.	12/15/2020 10:00 PM
14	It would be great to have a bike trail connect to Paw Paw.	12/15/2020 9:41 PM
15	N/a	12/15/2020 9:06 PM
16	More toddler swings	12/15/2020 8:51 PM
17	Bicycle trails paved would be so nice	12/15/2020 8:44 PM
18	More walking trails dog arras	12/15/2020 8:20 PM
19	Proud of our community and our parks	12/15/2020 7:45 PM
20	We need public walking paths that are safe and well maintained.	12/15/2020 5:55 PM
21	My granddaughters love the splash pad!	12/15/2020 5:33 PM
22	Splash Pad is great addition would like to see more improvements to park surrounding it including upgrading bathrooms.	12/15/2020 5:32 PM

23	None	12/15/2020 4:43 PM
24	Currently there is no local place for ATV riders to go in this area. The closest trail is over 3 hours away. Closest park is 2 hours away. ATV trail would bring in more people and provide increase to local economy.	12/15/2020 4:38 PM
25	Maintaining our youth fields is most important. Our children deserve the best.	12/15/2020 3:41 PM
26	None	12/15/2020 3:34 PM
27	Little league and rocket are definitely highest priority, but it would be nice to see improvements to trails.	12/15/2020 3:07 PM
28	The playground that we have now is poorly taking care of. I think you need to take care of what you have before you build new things.	12/15/2020 3:07 PM
29	None	12/15/2020 3:04 PM
30	I would love to see more nature and walking trails. Also more promotion of these trails.	12/15/2020 3:00 PM
31	We would LOVE to have pickle ball courts/updated tennis courts! Right now we drive to Paw Paw or Kalamazoo to play pickle ball, but we'd LOVE being able to play here. We'd also frequently use walking/biking trails!! If we had kids, I think my husband and I would use the current parks more often because they look so fun. At this point though, my husband and I wish there were more things available for adults who like to get outside (other than walking around the village).	12/15/2020 3:00 PM
32	I wouldn't categorize "Canon Park" as a "park" - it holds a picnic table and a refuse can. And a monument. For it to be a "park" it would seem that there might need to be a bit more space there and definitely an amenity or two. I had to puzzle a minute to identify this "park" in my mind; I would guess that most folks recognize only one park in the Village, and it is on the outskirts of the Village at that.	12/15/2020 2:53 PM
33	keep up the good work	12/15/2020 2:52 PM
34	Keep working on trimming trees for better visibility into activities in the park. Great work on updates and improvements!	12/15/2020 2:52 PM
35	Parks always seem to be clean and maintained.	12/15/2020 2:31 PM
36	We love the parks in Lawton and would appreciate some walking and biking trails as well.	12/15/2020 2:30 PM
37	Would love to see kids dream have a face lift, and re-create activities there, now that the water park is there!	12/15/2020 2:21 PM
38	Why not use the current green space in town across from barn brewers as a sitting area with tables or benches and offer outdoor seating for the local restaurants. It would be a VERY welcoming site for visitors and make our small town very likable. Take carry out food over to that area to enjoy by all. You could fit ALOT of tables and landscaping to make it beautiful.	12/15/2020 2:19 PM
39	Thank you for your focus on this important issue.	12/15/2020 1:08 PM
40	We've occasionally seen older kids hanging out at the dream not really playing, just sitting. I didn't notice any mischief going on, but if they had a skate park or floor hockey area maybe they wouldn't be bored and open to finding trouble to get into. This could turn into games during summer fest or all summer long. A floor hockey tournament during summer fest over the weekend, or just a small league all summer/winter long for those who can skate on ice or just can't and want to play on foot.	12/15/2020 12:59 PM
41	Thank you for allowing me to participate. I look forward to becoming more familiar with the community!	12/15/2020 12:57 PM
42	Would love to see a dog park!	12/15/2020 12:24 PM
43	I think Lawton has and is doing a great job with it's parks and recreation.	12/15/2020 12:12 PM
44	Over all I think the addition of the splash pad has been a huge asset to the community. I have seen a lot more people using the park even in a pandemic	12/15/2020 11:54 AM
45	Maybe a band stand and an activities coordinator	12/15/2020 11:49 AM
46	Would love to have ATV park or trails. Walking and bike trails would be amazing	12/15/2020 11:45 AM

47	Walking trails would be good, if you are going to connect to other trail networks, then they should be a multi use trail. (ie- bicycle, horseback, snowmobile.	12/15/2020 11:38 AM
48	Basketball courts should be moved to Field near HS. Similar to Hartford Schools set up. Current ones fill with water too easily and are too near little kids	12/15/2020 11:31 AM
49	This is a vital initiative to ensure our town continues to thrive and our citizens remain active and connected to one another! So important for maintaining a strong sense of community!! Bravo!	12/15/2020 11:26 AM
50	It would be great to have a trail system that loops from our parks to the high school with meandering in between, this would be great for hiking, biking and running, Portage has an excellent system and it is very popular	12/15/2020 9:18 AM
51	Need to attempt some volunteer monitoring during high usage times. Have heard of several complaints reference of older kids and improper behavior. The police have checked it often but they can't be there all the time. It would add to the use of our parks to try and obtain a few presentations every summer, regarding any number of things. I.e. local history, natur	12/14/2020 8:01 PM
52	I think that the restrooms should be expanded to accommodate more users at one time.	12/14/2020 6:31 PM
53	Maintaining Kids Dream and the Splash Park are very high priorities. There are parts of Kids Dream that need repairs now.	12/14/2020 12:08 PM
54	Na	12/10/2020 6:31 PM